



**19 OCTOBER 2022**

## EG TO HOST GRAND OPENING OF THE NEW SIGMA HEALTHCARE DISTRIBUTION FACILITY 21 OCTOBER 2022

**19 October 2022** – (Sydney, Australia) EG together with pharmaceutical wholesaler and distributor company, Sigma Healthcare (ASX: SIG), is excited to open a new critical storage and distribution centre in Bridgewater, Tasmania.

Located in a newly formed industrial estate, Bridgewater is 22 kilometres from the Hobart CBD. The facility will be formally opened on **Friday, 21 October at 9:30am** by EG's Chairman, Dr Michael Easson AM and Sigma CEO Vikesh Ramsunder.

"Strengthening Sigma's pharmaceutical supply chain in Australia with this significant facility serves to benefit both consumers in Tasmania as well as EG's investor community," stated Rodney Walt, Head of Private Wealth at EG.

"Sigma has a long and proud history of over 100 years in Australia and some very long-serving, loyal team members in Hobart. This purpose-built site will allow us to supply over 7 million units of essential medicines and related products to pharmacies across Tasmania every year," stated Vikesh Ramsunder, CEO at Sigma.

"EG's focus on long-term relationships is demonstrated by our ability to engage with a quality customer like Sigma to deliver to our investors a de-risked development project that is anticipated to offer robust risk-adjusted returns for our clients'." stated Sean Fleming, EG's Head of Capital Transactions.



Founded in 2000, EG has \$5.1 billion under management on behalf of super funds and private wealth clients to generate outstanding returns with lasting social impact. With \$3.9 billion in development pipeline, and 16.7% per annum in realised IRR for institutional funds, EG is committed to finding a better path to better returns.

- ENDS -

## **Sigma Healthcare distribution facility**

**Location** - 20-22 Woodrieve Road, Bridgewater 7030 TAS

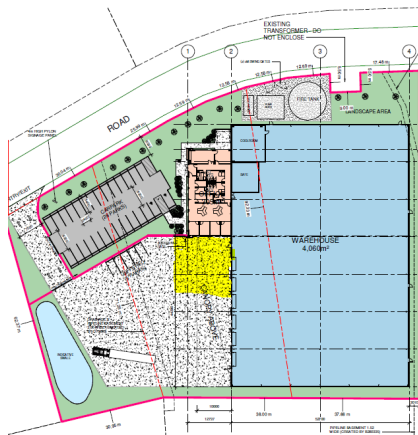

**EG Funds Management Pty Ltd**

ABN. 22 108 198 492

Governor Phillip Tower  
Level 21, 1 Farrer Place  
Sydney NSW 2000 Australia

T. +61 2 9220 7000  
[www.eg.com.au](http://www.eg.com.au)

## **A BETTER PATH TO BETTER RETURNS.**

EG is a disciplined, data driven investment manager and developer with over \$5.1 billion in assets under management.

We are committed to investing in property technology, keeping super funds and private wealth clients ahead in both rising and falling markets.

Our success is underpinned by B.I.G. Thinking®. We uncover what's truly best for both communities and investors.

We build in good, so you can build in growth.

**For further information please contact:**

**Angela Maxwell**  
+61 02 9220 7044  
+61 450 450 154  
[amaxwell@eg.com.au](mailto:amaxwell@eg.com.au)

**Jacqui Willing**  
+61 02 9220 7014  
+61 458 727 494  
[jwilling@eg.com.au](mailto:jwilling@eg.com.au)

